

KM SCR [Silicone Compatible Rubber] Setting Block for Glazing Systems



Material Description

SCR (Silicone Compatible Rubber) Setting Block is installed to provide stress relief when glass expand and contract over varying temperature conditions. SCR Setting block is designed for use in compression glazing systems, structural glazing systems, structural glazing systems and wet glazing systems.

It is also designed to keep glass from shifting in glazing pocket during transportation unitized frames.

Key Performance Properties

- Compatible with all **GE Silicone Sealants**
- Excellence Heat Aging / Ozone Resistance



Applications:

Setting blocks work best when they are spaced and sized appropriately. A minimum of two setting blocks should be placed on each of the edges of the sash, serving to distribute weight evenly. The larger the pane of glass, the longer the setting block should be. It is also advisable to use the same gauge (thickness) of setting block on the left as you do the right, and the top as you do the bottom. If possible using the same gauge setting block on all four sides will promote even displacement and is optimal.

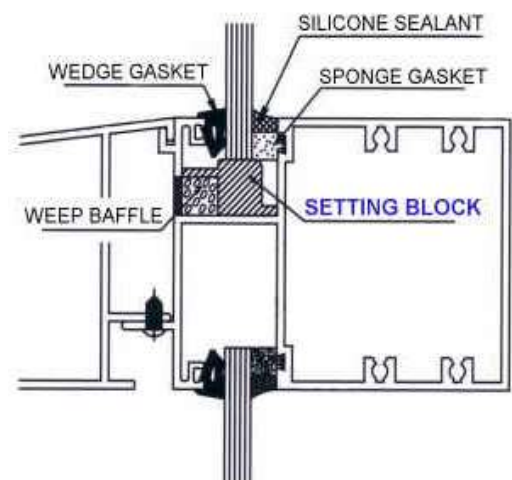

Product Technical Data

Property	Performance	Test Method
Hardness, Shore A	80	ASTM D2240- 03
Compression Set (100°C @ 22 hrs)	23 %	ASTM D395- 03, Method B
Ozone Resistance (100 MPa, 40°C @ 100hrs, 20% Elongation)	No Crack	ASTM D1149- 99
Tensile Strength	15.7 MPa	ASTM D412- 98a (2002)
Tear Strength	29.7 kN/m	ASTM D624-00e1 (Die C, V-500 mm/min)
Elongation at Rupture, Die C (V: 500mm/ min)	228 %	ASTM D412
Heat Ageing Properties, 100°C, 70 hrs		ASTM D573- 99
Hardness Change	+1 Points	
Tensile Strength Change	+ 3 %	
Elongation Change	- 34 %	
Brittleness Temperature	- 40 °C	ASTM D746- 04